



# DAY-O-LITE

## Harmony Series | HMLP 2x4

Date

Notes

Project

Type

Qty



Direct

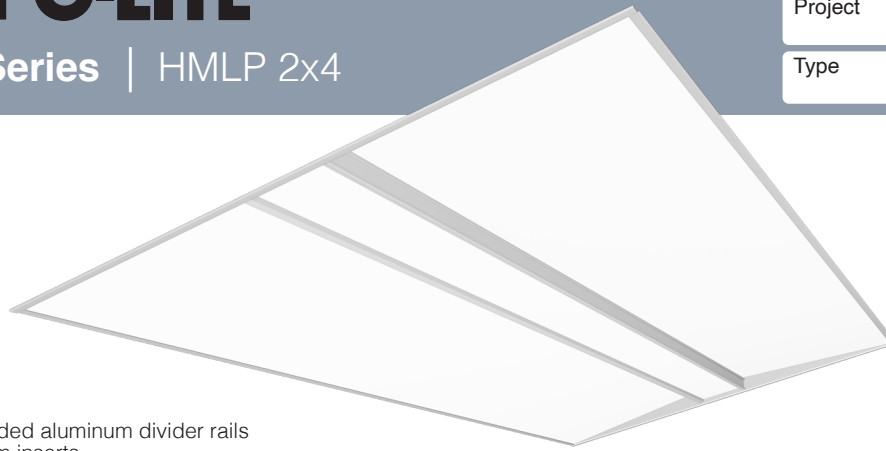

### Features

Steel housing, extruded aluminum divider rails w/specular aluminum inserts.

High performance 125LPW+ efficacy, DLC Premium.

For installation in a wide variety of suspended grid ceilings, including Slot Grid and Tegular.

High efficiency driver for custom lumen packages. 0-10V dimming to 1% standard.

High efficacy LEDs in 80 or 90 CRI; two or three channel tunable white; tunable color.

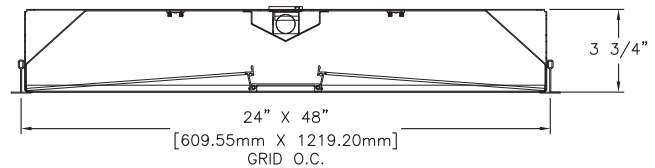

### Ordering Guide

MODEL	OPTICS	CCT	LUMENS <sup>1</sup>	SIZE	MOUNTING <sup>2</sup>	FINISH	OPTIONS
<b>HMLP-A-D</b>	<b>SI</b>		<b>SO</b>	<b>24</b>			
HMLP-A-D Direct	SI = Satin Ice Acrylic Lenses	35 = 3500K 80CRI 40 = 4000K 80CRI	SO = Standard Output  3500K: 6960L (53W, 131LPW) 4000K: 7090L (53W, 134LPW)  All values are nominal.	24 = 2x4	G = Grid MG = Mini Grid  SG = Slot Grid  S = Surface F = Flange  See all mount- ing options page 2.	W = White  CC = Custom Color  AMW = Anti-Microbial White	<b>DIMMING DRIVERS</b> DIM10 = 0-10V (1.0%) - <b>Standard</b> DIMSR = 0-10V (5.0%) Sensor Ready DALI = DALI (5.0%)  <b>LUTRON™ DIMMING DRIVERS</b> LDE1 = Hi-Lume™ 1% EcoSystem™ LDE5 = 5-Series 5% EcoSystem™ L3DA3W = Hi-Lume™ 1% 3-Wire LTEA2W = Hi-Lume 1% 2-Wire 120V  <b>SENSORS &amp; CONTROLS</b> ESN = Philips™ EasySense DAY = Daylight Harvesting OCC = Occupancy Sensor CAS = Casambi Bluetooth control VDO = Vive Sensor by Lutron  <b>EMERGENCY</b> EMC = Emergency Circuit GTD = Generator Transfer Device EPC4 = 4W Emergency Battery Pack EPC7 = 7W Emergency Battery Pack EPC10 = 10W Emergency Battery Pack EPC12 = 12W Emergency Battery Pack

<sup>1</sup>Delivered Lumens are Standard Output (SO) and Low Output (LO) at 80+CRI 4000K CCT. Use multipliers to estimate delivered lumens at other CCTs: 2700K = 0.94, 3000K = 0.96, 3500K = 0.98, 5000K = 1.02.

<sup>2</sup>See page 2 for ceiling mounting options details and full specifications.

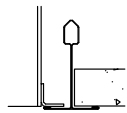
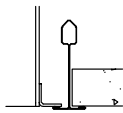
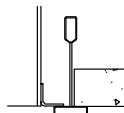
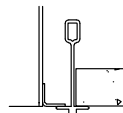
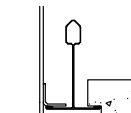
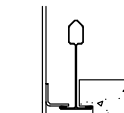
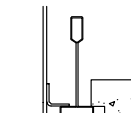
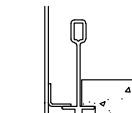

## Mounting Options

15/16" T-Bar  
(G)9/16" T-Bar  
(MG)Slot Grid  
(SG)Interlude  
(XG)15/16" Tegular  
Flush  
(TGF)9/16" Tegular  
Flush  
(MTGF)Slot Grid Flush  
(SGF)Interlude Flush  
(XGF)

## Drywall Ceiling

Mounting Detail

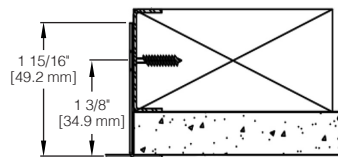

Flange Kit for drywall ceilings available:

FK-14 for 1x4  
FK-22 for 2x2FK-24 for 2x4  
FK-44 for 4x4

## Grid Ceiling

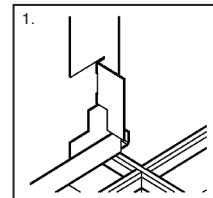
Five-step Universal  
Installation Sequence.*Complete Installation  
Instructions for grid  
and drywall ceiling types  
are available at:  
[www.dayolite.com](http://www.dayolite.com)*

Position Fixture

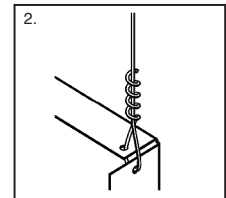

Secure Tie Wire

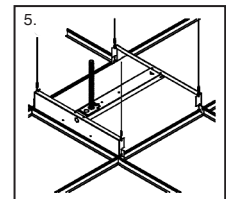
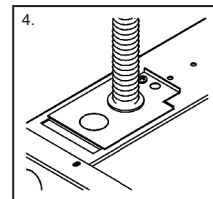
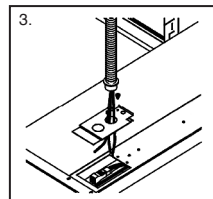

## Photometry

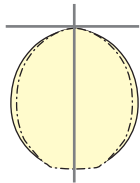
**HMLP-A-D-SI-P35-SO-24**CCT: 3500K  
WATTS: 53  
LUMENS: 6968  
LPW: 131  
Distribution:  
100% Direct**HMLP-A-D-SI-P40-SO-24**CCT: 4000K  
WATTS: 53  
LUMENS: 7096  
LPW: 134  
Distribution:  
100% Direct

## Specifications

**CONSTRUCTION:** 20 gauge CRS housing and internal components. Extruded Aluminum divider rails with specular aluminum inserts.**REFLECTOR:** 20 gauge CRS finished in highly reflective baked white enamel with pre-finished reflective LED tray.**OPTICS:** LED optimized Satin Ice (SI) acrylic lay-in lenses.**LED:** LED modules in 30/35/40 & 50K CCT, 80 CRI.  $L_{70}$  = 50,000 hours. 3 SDCM color consistency; field replaceable.**DRIVER** Standard driver is Class 2 AOC 0-10V to 1%, 120/277V input, PF > 90%, THD < 20 @ 120V. Additional dimming protocols available. All drivers prewired from factory for connection to control system (by others); field replaceable.**MOUNTING:** Standard installation is in an exposed inverted T-bar ceiling. Fixtures are supplied with four support brackets for additional support to T-bar. May also be installed in a plaster ceiling (F/TRL mounting option with Flange).**FINISH:** Housing and components finished in baked white enamel.**CERTIFICATION:** Luminaires are cETLus listed conforming to UL STD. 1598 and certified to CSA STD C22.2 NO. 250.0. Suitable for dry & damp locations. Union Made in the United States of America. I.B.E.W. RoHS compliant.