



Harmony Series | HML 1x4

Date

Notes

Project

Type

Qty



Direct



Note DLC options at bottom of page.

Features

Steel housing, extruded aluminum divider rails w/specular aluminum inserts.

LED optimized optics for smooth even illumination without glare.

For installation in a wide variety of suspended grid ceilings, including Slot Grid and Tegular.

High efficiency driver for custom lumen packages. 0-10V dimming to 1% standard.

High efficacy LEDs in 80 or 90 CRI; two or three channel tunable white; tunable color.

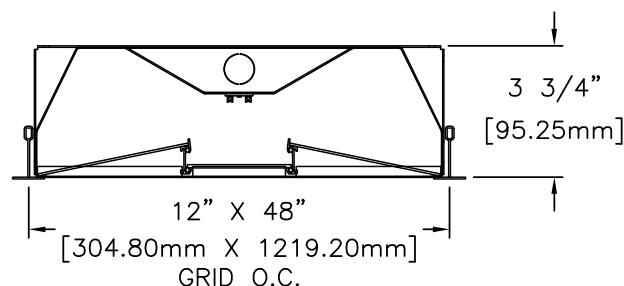

Ordering Guide

MODEL	OPTICS	CCT	LUMENS ²	SIZE	MOUNTING ³	FINISH	OPTIONS
HML-A-D				14			
HML-A-D Direct	SI = Satin Ice Acrylic Lenses (shown) FL = Flat Satin Ice Acrylic Lenses	27 = 2700K 80CRI 30 = 3000K 80CRI 35 = 3500K 80CRI 40 = 4000K 80CRI 50 = 5000K 80CRI 90 CRI add *9' Ex: 940 = 4000K @ 90 CRI TUNABLE WHITE & COLOR¹ <u>2-Channel White</u> 2DIM10 = for 0-10V 2DALI = for DALI 2DMX = for DMX 2PSQ = for Lutron 2SNS = for Signify 2CAS = for Casambi <u>3-Channel White</u> 3DLM = for DLM <u>3-Channel Color</u> RGB <u>4-Channel Color/White</u> RGBW <u>5-Channel Color/Warm White/Cool White</u> RGBWW	VLO = 3200L (30W, 107LPW) LO = 4200L (40W, 105LPW) SO = 5700L (56W, 102LPW) HO = 7125L (70W, 103LPW) VHO = 8900L (87W, 102LPW) Consult factory for additional lumen packages. All values are nominal.	14 = 1x4	G = Grid MG = Mini Grid SG = Slot Grid S = Surface F = Flange See all mounting options page 2.	W = White CC = Custom Color AMW = Anti-Microbial White	DIMMING DRIVERS DIM10 = 0-10V (1.0%) - Standard DIMSR = 0-10V (5.0%) Sensor Ready DIMST = Step Dimming (40%/100%) DALI = DALI (5.0%) LUTRON™ DIMMING DRIVERS LDE1 = Hi-Lume™ 1% EcoSystem™ LDE5 = 5-Series 5% EcoSystem™ L3DA3W = Hi-Lume™ 1% 3-Wire LTEA2W = Hi-Lume 1% 2-Wire 120V SENSORS & CONTROLS ESN = Philips™ EasySense DAY = Daylight Harvesting OCC = Occupancy Sensor CAS = Casambi Bluetooth control VDO = Vive Sensor by Lutron EMERGENCY EMC = Emergency Circuit GTD = Generator Transfer Device EPC4 = 4W Emergency Battery Pack EPC7 = 7W Emergency Battery Pack EPC10 = 10W Emergency Battery Pack EPC12 = 12W Emergency Battery Pack

DLC: DLC options are limited to SI Optics, 35/40K CCT @ 80CRI, SO lumens, all mounting, all finishes, and all options excluding DIMST.

¹Tunable white, tunable color and RGB/W options detailed on page 3 (not DLC applicable).

²Delivered Lumens are Standard Output (SO) and Low Output (LO) at 80+CRI 4000K CCT. Use multipliers to estimate delivered lumens at other CCTs: 2700K = 0.94, 3000K = 0.96, 3500K = 0.98, 5000K = 1.02.

³See page 2 for ceiling mounting options details and full specifications.

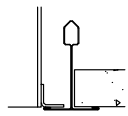
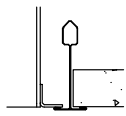
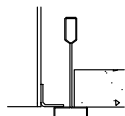
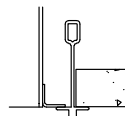
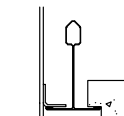
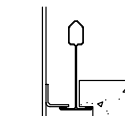
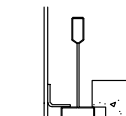
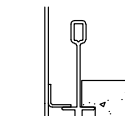

Mounting Options

15/16" T-Bar
(G)9/16" T-Bar
(MG)Slot Grid
(SG)Interlude
(XG)15/16" Tegular
Flush
(TGF)9/16" Tegular
Flush
(MTGF)Slot Grid Flush
(SGF)Interlude Flush
(XGF)

Drywall Ceiling

Mounting Detail

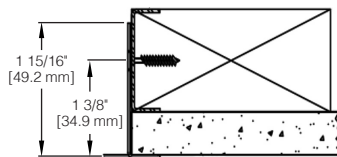

Flange Kit for drywall ceilings available:

FK-14 for 1x4
FK-22 for 2x2FK-24 for 2x4
FK-44 for 4x4

Grid Ceiling

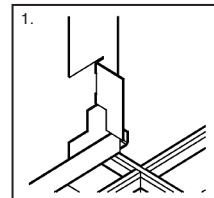
Five-step Universal
Installation Sequence.*Complete Installation
Instructions for grid
and drywall ceiling types
are available at:
www.dayolite.com*

Position Fixture

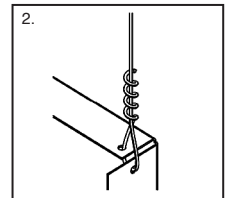

Secure Tie Wire

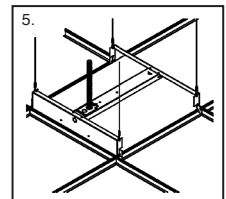
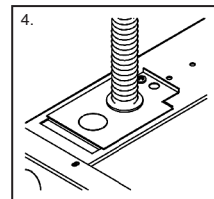
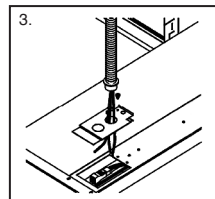

Photometry

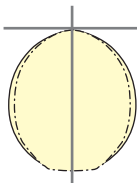
**HML-A-D-SI-40-VLO-14**CCT: 4000K
WATTS: 30
LUMENS: 3200
LPW: 107
Distribution:
100% Direct**HML-A-D-SI-40-LO-14**CCT: 4000K
WATTS: 40
LUMENS: 4200
LPW: 100
Distribution:
100% Direct**HML-A-D-SI-40-SO-14**CCT: 4000K
WATTS: 56
LUMENS: 5700
LPW: 100
Distribution:
100% Direct**HML-A-D-SI-40-HO-14**CCT: 4000K
WATTS: 70
LUMENS: 7125
LPW: 103
Distribution:
100% Direct**HML-A-D-SI-40-VHO-14**CCT: 4000K
WATTS: 87
LUMENS: 8900
LPW: 102
Distribution:
100% Direct

Specifications

CONSTRUCTION: 20 gauge CRS housing and internal components. Extruded Aluminum divider rails with specular aluminum inserts.**REFLECTOR:** 20 gauge CRS finished in highly reflective baked white enamel with pre-finished reflective LED tray.**OPTICS:** LED optimized Satin Ice (SI) acrylic lay-in lenses.**LED:** LED modules in 30/35/40 & 50K CCT, 80 CRI (90CRI available). $L_{70} = 50,000$ hours. 3 SDCM color consistency; field replaceable.**DRIVER** Standard driver is Class 2 AOC 0-10V to 1%, 120/277V input, PF > 90%, THD < 20 @ 120V. Additional dimming protocols available. All drivers prewired from factory for connection to control system (by others); field replaceable.**MOUNTING:** Standard installation is in an exposed inverted T-bar ceiling. Fixtures are supplied with four support brackets for additional support to T-bar. May also be installed in a plaster ceiling (F/TRL mounting option with Flange).**FINISH:** Housing and components finished in baked white enamel.**CERTIFICATION:** Luminaires are cETLus listed conforming to UL STD. 1598 and certified to CSA STD C22.2 NO. 250.0. Suitable for dry & damp locations. Union Made in the United States of America. I.B.E.W. RoHS compliant.Day-O-Lite, a division of SCW Corporation. All rights reserved. The Day-O-Lite logo is a registered trademark of SCW Corporation.
Day-O-Lite reserves the right to change specifications without notice for product improvement.

Day-O-Lite offers a variety of tunable white and tunable color options for a range of human centric applications and budgets. It is recommended that a recognized authority on the benefits and best practices of tunable white be consulted prior to specification. As a rule, fewer channels will provide a basic level of performance for budget conscious applications. Conversely, an increased number of channels, a wider CCT range, higher CRI and more precise color consistency may be more appropriate depending on the application and desired results.

HOW TO SPECIFY

Select from the various channel/control options below and insert desired **Ordering Code** into the **COLOR TEMP** column of the Ordering Guide on page 1. No need to add a dimming option as the codes include the chosen protocol.

2-CHANNEL TUNABLE WHITE OPTIONS

2700K - 6500K CCT range
1000L/ft LED modules @ 4000K
80+ CRI w/3SDCM color accuracy
10W/ft. nominal power

Ordering Codes

2DIM10 for 0-10V control
2DALI for DALI control
2DMX for DMX control
2PSQ for Lutron Quantum control
2SNS for control via Signify SNS sensors
2CAS for control via Casambi BLE wireless devices

LEGRAND BLANCO MULTI-CHANNEL OPTIONS

Blanco-2

Blanco-2 mixes two channels of white LEDs to approximate the blackbody curve for tunable white applications. CCT and intensity may be adjusted with controls by others.

3000K-5000K CCT range
1000L/ft LED modules @ 4000K
90+ CRI w/2SDCM color accuracy
10W/ft. nominal power

Ordering Codes

B2DLM for DLM control

Blanco-3

Blanco-3 mixes three channels of white LEDs across a wider range of color temperatures for more demanding tunable white applications. CCT and intensity may be adjusted with controls by others.

2700K-6500K CCT range
1000L/ft. LED modules @ 4000K
90+ CRI w/SDCM color accuracy
10W/ft. nominal power

Ordering Codes

B3DLM for DLM control

RGB & RGBW TUNABLE COLOR

RGB = Red, Green, Blue color mixing LEDs
RGB/W = Red, Green, Blue + White of chosen CCT
Dimming from 100% to 1%.
90+ CRI w/3SDCM color accuracy
10W/ft. nominal power

Notes:

RGB requires an RGB DMX or DALI controller (by others)

RGBW requires an RGBW DMX or DALI controller (by others)

All channels on one driver is standard, if isolating the White from the RGB channels is desired please consult factory.

RGB and RGBW are not recommended for tunable white applications.

Ordering Codes

RGB for DMX control
RGB27 for DMX control w/2700K white
RGB30 for DMX control w/3000K white
RGB35 for DMX control w/3500K white
RGB40 for DMX control w/4000K white
RGB50 for DMX control w/5000K white
RGB65 for DMX control w/6500K white
Add Suffix **DAL** for DALI Control to codes above.

5-CHANNEL TUNABLE WHITE AND COLOR

RGBWW = Red, Green, Blue, Warm White, Cool White.
Consult factory for RGBWW tunable white/color options.