



Harmony | HML 2X2

LED Luminaire



DATE		NOTES
PROJECT		
TYPE	QTY	



Recessed Direct



Integral Occupancy & Daylight Sensors Available

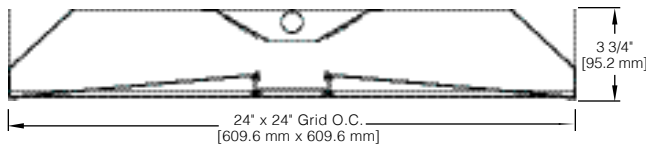

HOUSING: Die-formed, 20-gauge, cold rolled steel housin. Center divider rails are extruded aluminum with specular aluminum inserts.

REFLECTOR: Highly reflective, die-formed steel finished in baked white enamel is standard.

SHIELDING: LED optimized Satin Ice Acrylic.

LEDS: LED modules in 27/30/35/40 & 50K CCT, 80 CRI. Lumen maintenance minimum L_{70} = 50,000 hours. 3 SDCM color consistency. Zhaga™ compliant (Book 7). Field replaceable.

ELECTRICAL: Pre-wired Class 2 AOC electronic driver, 120/277V input, PF > 90%, THD < 20 @ 120V. 0-10V dimming to 1%. -20C to +50C operating range.

MOUNTING: Standard installation is in an exposed inverted T-bar ceiling. Fixtures are supplied with four support brackets for additional support to T-bar.

FINISH: Baked white enamel.

CERTIFICATION: Luminaires are cETLus listed conforming to UL STD. 1598 and certified to CSA STD C22.2 NO. 250.0. Inherently protected; suitable for insulated ceilings. Dry and damp location suitable. Union Made in the United States of America. I.B.E.W.

PERFORMANCE: DLC V4.3 Qualified luminaire; minimum 100 LPW efficacy. U.S DOE Lighting Facts® certified. Search for additional Day-O-Lite DLC qualified luminaires at www.designlights.org. Performance is U.S DOE Lighting Facts® certified.

Ordering Guide (choose from the lists below and specify options in yellow boxes)

MODEL	STYLE	DISTRIB.	SHIELDING	COLOR TEMP (CCT)	DELIVERED LUMENS	SIZE	MOUNTING	FINISH	OPTIONS ¹
HML	A	D	SI		SO	22			
HML	A = Angled Lens	D = Direct	SI = Satin Ice Acrylic	30 = 3000K..... 35 = 3500K..... 40 = 4000K.....	2840L (26.6W, 107LPW) 2880L (26.6W, 108LPW) 2925L (26.6W, 110LPW)	2x2	G = Grid MG = Mini Grid SG = Slot Grid F = Flanged (recessed) TRL = Trimless (recessed)	W = White CC = Custom Color AMW = Anti-Microbial White	DIM10 = 0-10V 1% Dimming ESN = Philips™ EasySense Wire-less Daylight & Occupany Sensor. OCC = Occupancy Sensor only DAY = Daylight Sensor only EPC4 = 4W Emergency Pack EMC = Emergency Circuit GTD = Generator Transfer Device LVC = Low Voltage Controller

¹See page two for all options.



LED Options

0-10V DIMMING DRIVERS

DIM10 = 0-10V (1.0%)
 DIMSR = 0-10V (5.0%) Sensor Ready²
 DIM100 = 0-10V (0.1%) Fade-to-Off
 DIMST = Step Dimming (40%/100%)
 DALI = Digital Addressable Lighting Interface

LUTRON™ DIMMING DRIVERS

LDE1 = Hi-Lume™ 1%-H EcoSystem™³
 LDE5 = 5-Series 5% EcoSystem™
 L3DAE = Hi-Lume™ 1% EcoSystem™
 L3DA3W = Hi-Lume™ 1% 3-Wire
 LTEA2W = Hi-Lume™ 1% 2-Wire FFC⁴

LUTRON™ WIRELESS MODULES

FCJECO = EcoSystem™ Wireless RF
 Fixture Module for EcoSystem™ LED drivers.
 FCJS-010 = EcoSystem™ Wireless RF
 Fixture Module for 0-10V products by others.

EMERGENCY BATTERY PACK (EPC)⁵ & WIRING OPTIONS

EPC4 = (4W) 430 Delivered Lumens
 EPC7 = (7W) 750 Delivered Lumens
 EPC10 = (10W) 1070 Delivered Lumens
 EPC12 = (12W) 1285 Delivered Lumens
 GTD = Generator Transfer Device
 EMC = Emergency Circuit

SENSOR⁶ OPTIONS

ESN = Philips™ EasySense
 DAY = Daylight Harvesting Sensor
 OCC = Occupancy Sensor

OPTIONS NOTES:

- ¹Standard 0-10V 1% with linear dimming curve. Add "LOG" to option code for 0-10V 1% logarithmic dimming curve.
- ²Philips™ Xitanium™ Sensor Ready driver for use w/integrated wireless sensors including Philips™ EasySense™, Enlighted™, EnOcean™, Digital Lumens™ and others.
- ³Hi-Lume 1%-H EcoSystem™ with Soft-On, Fade-to-Black™ dimming.
- ⁴120V two-wire forward phase control only.
- ⁵Delivered emergency lumens at 3000K CCT.
- ⁶Philips EasySense wireless daylight/occupancy sensor.

Day-O-Lite is a Lutron Advantage OEM Program Partner. Lutron drivers are backed by a 10 year warranty. For more information on Lutron™ LED drivers and controls please visit www.lutron.com.



Drywall Ceiling

Mounting Detail

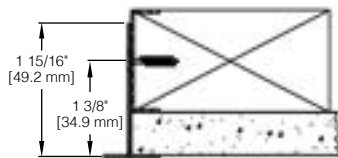

Flange Kit for drywall ceilings included with each fixture. Additional kits may be purchased separately.

FK-14 for 1x4 FK-24 for 2x4
 FK-22 for 2x2 FK-44 for 4x4

Grid Ceiling

Five-step Universal Installation Sequence.

Complete Installation Instructions for grid and drywall ceiling types are available at: www.dayolite.com

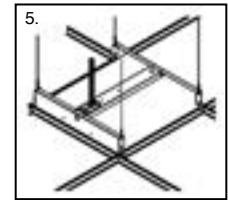
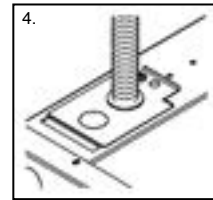
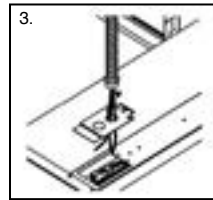
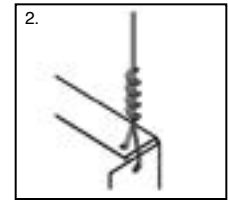
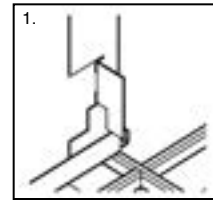

Grid Options

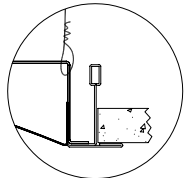

Mounting "G"
15/16" Inverted "T"

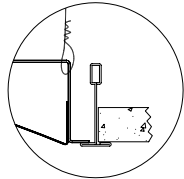

Mounting "MG"
9/16" Inverted "T"

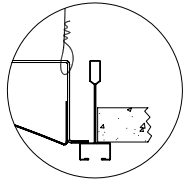

Mounting "SG"
Bolt / Slot Grid

Photometrics

CANDELA DISTRIBUTION

Vert. Angle	0	22.5	45	67.5	90
0	1266	1266	1266	1266	1266
5	1261	1260	1265	1266	1270
10	1243	1251	1218	1229	1246
15	1224	1217	1207	1192	1201
20	1168	1165	1153	1148	1150
25	1115	1108	1092	1095	1103
30	1065	1039	1038	1038	1031
35	973	966	967	970	957
40	901	887	886	890	896
45	819	803	807	811	817
50	717	706	709	713	715
55	626	615	609	616	614
60	511	505	505	504	513
65	403	398	399	397	396
70	296	290	293	288	287
75	196	195	191	190	191
80	115	112	111	111	110
85	49	48	51	47	46
90	9	10	9	8	7

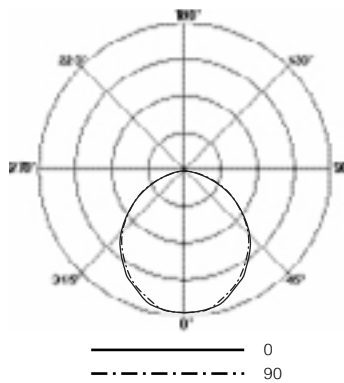

CCT: 4000K
 WATTS: 26.6
 LUMENS: 2925
 EFFICACY: 110 LPW
 Optical Distribution: 100% Direct

IES files available at www.dayolite.com