

Perimeter

JB

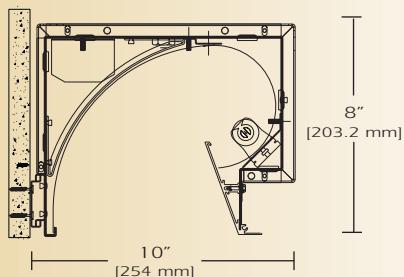

TYPE _____

FEATURES

The JB perimeter system is designed to produce diffused light with its concealed lamp source. Producing reflected horizontal illumination and disperses lamp imaging and socket shadows. Designed to produce no lamp image or reflection on mirrors its usage has expanded to meet today's interior designs. The JB series is engineered to provide easy installation for this specific architectural cove requirement.

SPECIFICATIONS

Housing: Fully assembled one-piece die form 20-gauge cold rolled steel with extruded aluminum ceiling trim. Standard lengths are up to 8 feet. All fixtures are self-flanged. Fixtures join together with alignment brackets and accept 1/4"-20 rods or tie wire. (Supplied by others) Locking alignment clips join reflectors. The fully assembled 8" x 10" housing mounts to continuous wall rail system which provides horizontal adjustment and ease of installation.

Reflector: Standard front reflector is die formed .025 semi-specular anodized aluminum, rear reflector is specular aluminum.

Electrical: Ballast is electronic, high power factor, thermally protected class P, sound rated A, with less than 20% total harmonic distortion. The minimum number of ballasts will be used unless otherwise specified.

Mounting: Recessed mounting for grid or flange ceilings.

Finish: Fixture housing and steel components are finished in baked white enamel applied over a five-stage pretreatment process.

Lamps: Fixtures are provided for use with one 32 watt T8 lamps, 28 watt T5, or 54 watt T5 HO lamps. (Supplied by Others)

Certification: Luminaires are U. L. Listed, C. S. A. certified and are Union Made in the United States of America I.B.E.W.

ORDERING GUIDE

MODEL NO.	LAMPS	MOUNTING	LENGTH	FINISH	VOLTAGE	OPTIONS
JB	-	-	-	-	-	-
JB	132T8 128T5 154T5 HO	G= Grid F= Flange O= Other Specify	2 3 4 6 8 for other, please enter row length (eg. 48=48ft)	W= White CC= Custom Color	120v 277v	See Options Below

Example: **JB-132T8-G-4-W-120V**
JB with one 32 watt T8 lamps grid ceiling application four foot fixture finished in baked white enamel 120v electronic ballast less than 20% total harmonic distortion

OPTIONS

- E10=** Electronic ballast, high power factor, thermally protected class P, sound rated A, < 10% total harmonic distortion
- DIM=** Dimming Ballast
- EPC=** Emergency Battery Pack
- EMC=** Emergency Circuit
- OTH=** See Accessories for other options available

Perimeter

JB

LINEAR SECTIONS AND SUSPENSION LOCATION

SUSPENSION MOUNTING

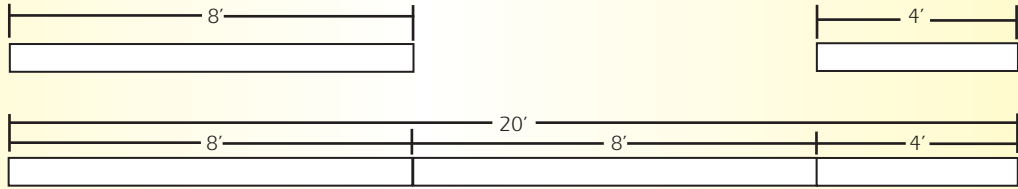

CORNERS

Corners and fixture extensions are custom fabricated to precise dimensions. Please indicate the specific requirements on the layout

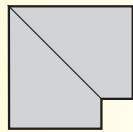

C2
90° Corner

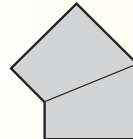

()° AC
Angular Corner

For any angular corner, ()° must be specified and dimensions must be included on the layout

For any pattern, a layout must accompany the order.

INSTALLATION PREPARATION

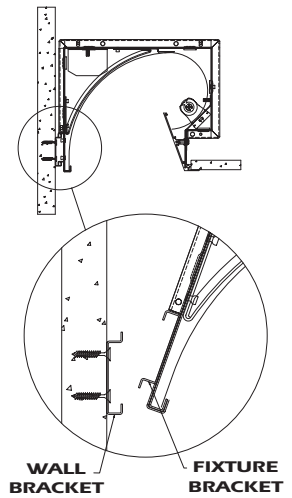
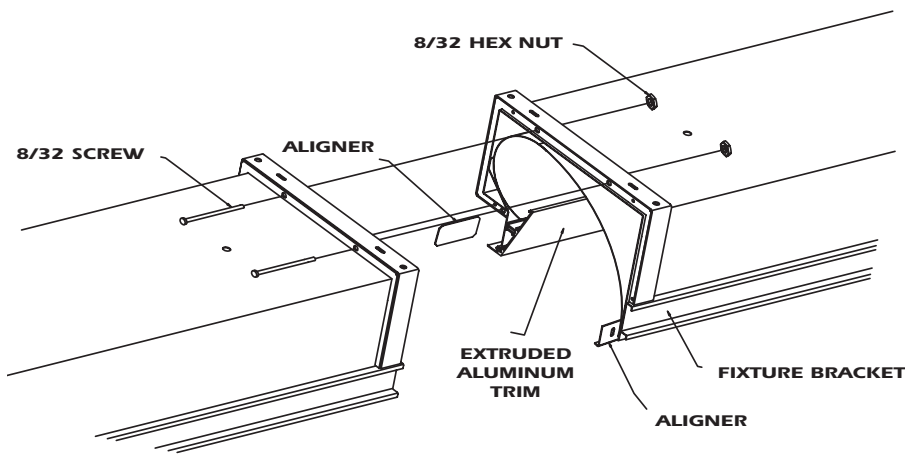

PHOTOMETRY

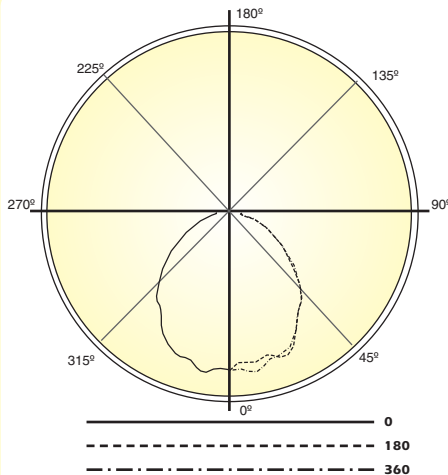

Candela Distribution:

Vert. Angle	225	247.50	270	292.50	315
0	745	745	745	745	745
5	666	707	698	716	727
10	731	715	748	695	741
15	725	712	695	628	643
20	711	693	627	569	557
25	668	657	545	387	345
30	623	600	413	266	236
35	588	513	294	228	273
40	531	434	230	355	364
45	488	339	265	345	358
50	422	282	306	294	239
55	352	225	277	111	23.4
60	271	196	184	31.9	22.9
65	203	176	91.7	35.0	8.87
70	164	150	79.7	16.6	2.78
75	107	103	48.2	9.81	2.84
80	49.2	79.2	39.5	9.25	1.58
85	20.6	59.5	44.8	9.78	0.860
90	10.4	56.3	38.8	5.96	0.230

Optical Distribution:
Direct

LAMP (1) 32W T8
LUMENS: 2900 PER LAMP

Coefficients of Utilization - Zonal Cavity Method:
pfc = 0.20

pcc	.8	.7	.5	.3	.1	0
pw	.7 .5 .3 .1	.7 .5 .3 .1	.5 .3 .1	.5 .3 .1	.5 .3 .1	0
RCR	0	1	2	3	4	5
0	61 61 61 61	60 60 60 60	57 57 57	55 55 55	53 53 53	51
1	57 55 53 51	55 54 52 50	51 50 49	49 48 47	48 47 46	45
2	52 49 46 43	51 48 45 42	46 44 41	44 42 41	43 41 40	39
3	48 43 40 37	47 43 39 36	41 38 36	40 37 35	38 36 34	33
4	45 39 35 32	43 38 34 31	37 34 31	36 33 31	35 32 30	29
5	41 35 31 28	40 35 31 28	34 30 27	33 29 27	32 29 27	26
6	38 32 28 25	37 31 27 24	31 27 24	30 26 24	29 26 24	23
7	36 29 25 22	35 29 25 22	28 24 22	27 24 22	27 24 21	20
8	33 27 23 20	32 26 22 20	26 22 20	25 22 19	24 22 19	18
9	31 25 21 18	30 24 20 18	24 20 18	23 20 18	23 20 18	17
10	29 23 19 16	29 23 19 16	22 19 16	22 18 16	21 18 16	15



Total Luminaire Optical Efficiency = 52.50%